

Use and maintenance instructions

BASEPLAST 400 / 500 + SFERA 400 / 500



Via S.Croce n°121 z.i.
47032 Berinoro (FC) Italia

Outdoor luminaire suitable for installation on Ø60mm pole/bracket

TECHNICAL DETAILS: refer to the product label

The UE declaration of conformity can be downloaded from our website www.marecoluce.it

Insulation Class II

IP65 Protection degree against dust ingress, solid particles, moisture

This product must not be disposed as a normal household waste

WARNINGS:

- THE SAFETY OF THIS PRODUCT IS GUARANTEED ONLY WITH THE RESPECT OF THE EXISTING RULES FOR THE ELECTRICAL SYSTEMS AND WITH THE APPROPRIATE USE OF THESE INSTALLATION INSTRUCTIONS, THEREFORE IT IS NECESSARY TO KEEP THEM.
- THE IMPROPER USE OF THIS PRODUCT IS FORBIDDEN; ANY TAMPERING WITH THE PRODUCT OR MODIFICATION OF THE PRODUCT THAT IS NOT AUTHORIZED BY MARECO LUCE CAN CAUSE DAMAGE TO PEOPLE, ANIMALS OR THINGS AND WILL VOID ANY WARRANTY OR LIABILITY.
- SWITCH OFF THE ELECTRICITY BEFORE CONDUCTING ANY KIND OF MAINTENANCE.
- THE PRODUCT MUST BE INSTALLED IN ACCORDANCE WITH BEST PRACTICE.
- DAMAGED COMPONENTS MUST BE REPLACED WITH MARECO LUCE ORIGINAL SPARE PARTS.
- FOR PRODUCT 2000755N WITH DIFFUSER 2050500B IS MANDATORY THE USE OF THE ACCESSORY 1472300A.
- FOR PRODUCT 2000755N WITH DIFFUSERS 2050500F OR 2050500T IS MANDATORY THE USE OF THE ACCESSORIES 1469200A OR 1473200A.

GENERAL MAINTENANCE RECOMMENDATIONS:

- CLEAN THE LUMINAIRE PERIODICALLY IN ORDER TO REMOVE DIRT DEPOSITS ON THE DIFFUSER AND IN THE DRAINAGE HOLES OF THE BASE (LOCATE THEM BY USING THE INSTALLATION INSTRUCTIONS).
- CHECK THE TIGHTNESS OF THE SCREWS SECURING THE LUMINAIRE TO THE POLE.
- CHECK THE INTEGRITY OF THE DIFFUSER AND REPLACE IT IN CASE OF DAMAGE, BY USING ONLY AN ORIGINAL MARECO LUCE DIFFUSER.
- DO NOT USE HARSH DETERGENTS TO CLEAN THE DIFFUSER.
- CHECK THE PLASTIC CASINGS CAREFULLY IN ORDER TO IDENTIFY ANY POSSIBLE INSULATION DAMAGE.

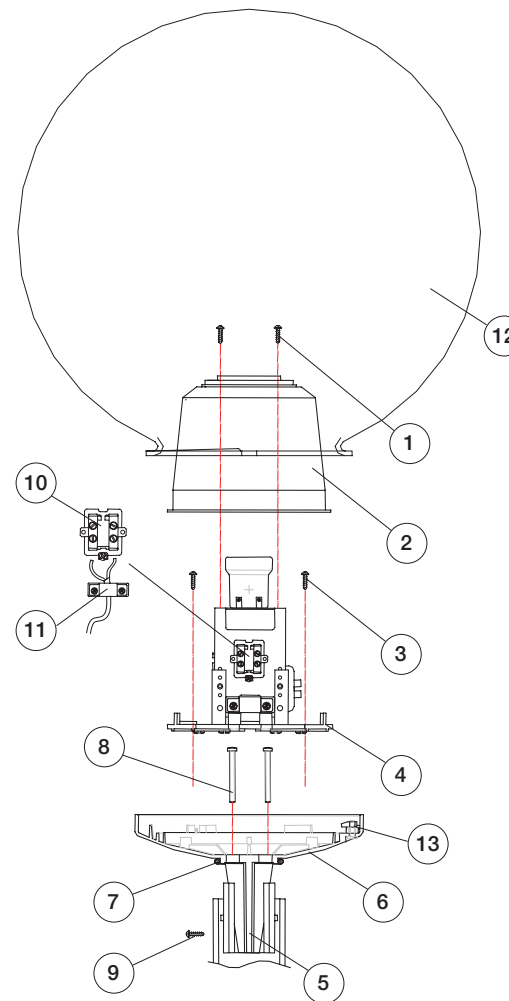
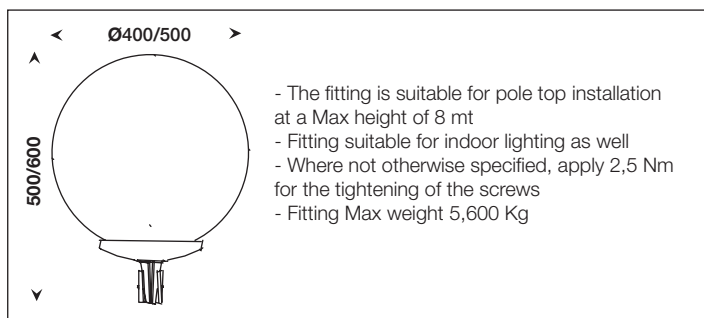
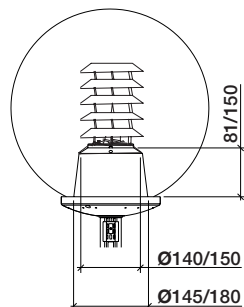

INSTALLATION INSTRUCTIONS:

1. Twist off the fixing screws (1), and extract the cone (2).
2. Loosen the fixing screws (3) of the components holding plate (7), and then remove the plate by making it turning anti-clockwise.
3. Insert the supply cable in the hole placed in the fixing part (5) of the base (6);
CAUTION: use only a flexible double insulation sheath (type HAR). The outer cable diameter must be less than 13mm and the thickness of the inner electrical wires must range between 1 and 2.5mmq.
4. Insert the fixing part (5) into the pole top/bracket, paying attention to the correct positioning of the gasket (7).
5. Tighten the screws (8) of the expanders equally to ensure the fixing of the base (6) on the pole.
CAUTION: In case of downlight mounting, tighten the screw (9) (not included) and make sure that the base (6) is firmly anchored to the arm.
6. Connect the conductors to the clamp (10), and fix the cable in the anchoring device (11).
7. Position the components holding plates (4) on the base (6) paying attention that the shaping of the external plate profile matches the notch of the base (6).
8. Turn the components holding plate (4) clock-wise up to the correct positioning of the fixing holes, and then tighten the screws (3).
9. Insert the cone (2) paying attention that the reference groove of the cone matches the notch on the wiring-holder plate (4).
10. Tighten the screws (1).
11. Install the lamp and louvre (if requested), following the proper instructions.
12. Insert the diffuser (12), turn it about 60 ° and tighten the three fixing screws (13) (apply 1Nm) placed on the bottom of the base (6).

• MAX LAMP DIMENSION ALLOWED (MM):

- o FBT 24W E27 D100 L190 (Ø400)
- o FBT 33W E27 D100 L200 (Ø500)

